

Buchi r-200 user manual

10 Spare parts

10.2.4 'DB' configuration

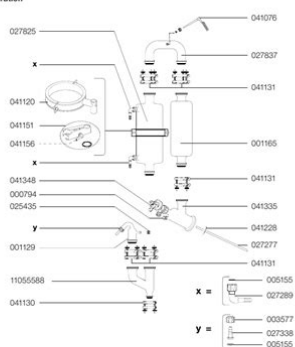

List of articles

Order no.	Part name	Order no.	Part name
000794	Screw cap SVL 15	027825	U-tube to Bulftrog plug
001129	Vacuum-connection	041076	Temperature sensor B, cpl.
001165	Expansion vessel	041120	Glass holder Bulftrog, cpl.
1105568	Y-connection receiver	041130	EasyClamp DN 25 cpl.
003577	Screw cap SVL 22	041131	EasyClamp DN 40 cpl.
005155	O-ring	041151	Pneumatic clamp, cpl.
005435	Screw cap GL 14	041156	Clamping lever
027277	PTFE hose, outer diam. 10.0x1.0	041228	Set PTFE-disks (set of 10)
027289	Filling SVL 22	041335	Distribution piece descending
027338	Hose nipple SVL 22	041348	Inlet valve cpl.
027825	Bulftrog 2 plug		

98

R-220 SE Operation Manual, Version F

File Name: Buchi r-200 user manual.pdf

Size: 1310 KB

Type: PDF, ePub, eBook

Category: Book

Uploaded: 13 May 2019, 14:54 PM

Rating: 4.6/5 from 730 votes.

Download Now!

Please check the box below to proceed.



I'm not a robot



reCAPTCHA
Privacy - Terms

Book Descriptions:

Buchi r-200 user manual



No part of these This can be done by hand or with the supplied tool. Only authorised repair personnel can remove protective equipment and covers with the help of conventional tools. Glass assemblies with diagonal condensers, for standard distillations with vertical condenser, for standard distillations, 17 cm less place requirement than glass assembly A. The basis of this procedure is the evaporation and condensation of solvents using a rotating evaporating flask. It is important that you detect any transport damages when you unpack. If necessary, you must prepare a status report immediately informing postal company, railway company or transportation company. All materials, which come into contact with chemicals are made of glass, PTFE and ETFE. In this case the tension of the rope has to be adjusted. This can be done by the customer. If you order R205, this display module is already installed. When the Rotavapor is turned on by, the rotation speed starts with the preselected rotation speed. Thus, make sure that there is always heating bath liquid in the bath. Then, continue distillation. Repeat this process until all desired solvent is distilled off. At the end of distillation, start rotation, pull up the flask and vent the system. To guaran tee this, operations should be performed according to this rule of thumb. This includes periodically cleaning and checking for damages. Before carrying out maintenance work on the apparatus, make sure that vapour supply and current supply have been turned off. Press the button on the bottom of the drive to block the screwed connection. Vacuum tightness The apparatus is evacuated while flask is rotating. If there is a pressure measuring device, it is determined whether the vacuum remains constant in the system. As a result, people will not be injured from contact with dangerous substances. Residues of chemicals must be removed completely and glass components must be cleaned. <http://www.bleha.eu/KUBA/bleha/userfiles/dcp-560cn-manual.xml>

- **buchi r-200 user manual, buchi rotavapor r-200 operation manual, buchi r-200 manual, buchi r-200 user manual pdf, buchi r-200 user manual download, buchi r-200 user manual free, buchi r-200 user manual 2017.**



Table 3-2: Optional accessories (cont.)

Product	Order number
Heating bath B-491 with digital display for 20 °C to 180 °C	
Heating bath complete 230 V 50/60 Hz	48200
Heating bath B-491 complete 100–120 V 50/60 Hz	48201
Heating bath B-491 for R-200/S complete 230 V 50/60 Hz	48212
Heating bath B-491 for R-200/S complete (100–120 V 50/60 Hz)	48213
Heating bath platform for R-200/S	47972
Heating Bath B-495 for flask sizes up to 5 l with digital display for 20 °C to 95 °C, bath replenishment and level adjustment	
Heating bath complete 230 V 50/60 Hz	48340
Heating Bath B-495 complete 100–120 V 50/60 Hz	48241



Protective shield complete for B-491	48052
--------------------------------------	-------



Stop-position extension	44466
-------------------------	-------



During assembling and disassembling the general safety rules and Chapter 6 are to be respected. As a result, energy consumption is reduced. 250 pieces 36405 Picture 47 Floating balls in waterbath. You can make a request for the operating manual by completing the adjoining form. Subsequently, you will receive the operating manual as pdf file. Visit our Shop Request a PDF Therefore, you will receive offers and information about relevant topics by email or post. You can unsubscribe from this notification at any time. Page Count 5 Download Open PDF In Browser View PDF AboutQuote RequestShopRotavapor System. Item Number R200 System. Manufacturer Buchi. Product Category Evaporators. Brand Name Buchi. Description Buchi R200 Rotavapor SystemHave a quote from somewhere else Click Here. AddtoAdd. Quote. SKU 0558ae2347f4. Category Evaporators. Description. Additional informationItem Number R200 System. Reviews 0. Product Overview Buchi R200 Rotavapor System. Overview of Buchi R200 Rotavapor System. Buchi R200 Rotavapor System is available from Laboratory. Controls LLC. This product comes with a 90 day warranty. Specifications. Resources. Buchi R200 Rotavapor System ManualWarranty Information. Laboratory Controls offers a best in the business full 90 dayPlease contact us for further informationRelated products. Buchi B720 Vacuum. Controller. Caliper Life Sciences Turbo. LV EvaporatorAdd. QuoteControllerAdd. QuoteContact Us. Site Info. Phone Hours. Social Media. Customer Phone. Order Tracking. Monday Thursday. Laboratory Controls. Number. PoliciesFacebookFriday 8am 6pm. PageLaboratory. CareersU.S. Customer. Privacy Policy. Saturday Sunday. EmailMailRowland Rd UnitStorefront designed by WooCommerce.File Type Extension pdf. PDF Version 1.6. Linearized No. Create Date 20170710 1112250400. Creator Google Chrome. Modify Date 20170710 1112300400. Has XFA No. Metadata Date 20170710 1112300400. Creator Tool Google Chrome. Title Buchi R200 Rotavapor System.<http://sirinthepgroup.com/userfiles/dcp-7020-brother-manual.xml>

Operation Manual Rotavapor® R-210/215

BUCHI



093076_en

Document ID uidd584923cb38d4f4ea00bc1e8fecfe7a7. Instance ID uidd69110666d6d47898e2a2ef71a777269. Producer Acrobat Web Capture 15.0. Page Count 5. Evaporator with coldtrap condenser assembly Twopiece coldtrap condenser style is ideal for lowboiling solvents. Uses mechanical refrigeration or dry ice and acetone. Tapwatercooled. Inlet feed tube for continuous feed of volumes exceeding flask capacity. 3STEP SELECTION GUIDE 1. Choose Glassware Diagonal condenser, Vertical condenser, Coldtrap condenser 2. Choose Evaporator Model R200 Fullyequipped base model R205 Base model, plus digital vapor temperature display 3. Choose Level BASIC Features of the selected evaporator model. ADVANCED Features of the selected evaporator model, plus integrated, semiautomatic V800 vacuum controller. Remote rotation speed and servojack control optional. PROFESSIONAL Features of the selected evaporator model, plus integrated, programmable V805 vacuum controller. Remote rotation speed and servojack control optional. In many cases a COA can be faxed In many cases a COA can be faxed If so click here. Reproduction of any materials from the site is strictly forbidden without permission. SigmaAldrich Products are sold exclusively through SigmaAldrich, Inc. Contents. Index. Technische Spezifikationen. Technical specifications. Specifications techniques Assembling. Assemblage Notes and tips. Conseils et recommandations Page Schema de cablage Hebestativ. Lifting stand. Statif elevateur Temperature probes. Sondes de temperature Accessories. Accessoires Induktionsmotor elektronisch. Drehzahl Ölbad 471 Oilbath 471 Vakuumdichtheit Bestellcode 11137. Jammed vapour duct. Tube conduit de vapeur coincide. Use extractor code 11137 to remove Extracteur, code 11137, permet. Wasserbad. Wird im Wasserbad deionisiertes Oder Waterbath. If the waterbath is operated with deionised or distilled water it is necessary Bain marie. Si le bain marie est utilis6 avec de leai Ölbad.

Nebst Warmetrageröl kann auch wasserlösliches Polyalkylenglykol oder PEG Ölbad. Besides heat transfer oils, water soluble. PEG or polyalkylene glycole may be Bain d'huile. A part les huiles thermiques, on peut Ersatzteile. Damit Ersatzteile schnell und richtig Spare parts. To process your order fast and correctly Pieces de rechange. Pour que les pieces de rechange arrivei Dont hurt the lip of the seal. Blasaufbauten. Glass assemblies. Assembly RE A. Vufbau RE A. Assemblages de verre.

Assemblage RE AAssemblage A Glass assembly A compl. for RE. Assemblage A compl. pour RECondenser. RefrigerantCondenser with screw capRefrigerant avec ecrou chapeauGasket KD22. Joint KD22PTFE tube, 460 mm. Tuyau PTFE, 460 mm. Screw cap with insert spring. Couplage avec ressort. Introduction stopcock compl. Robinet d'introduction compl. KSClip. KSPince. Vapour duct. Conduit de vapeur. Saveclip 29. Agrafe de securite 29. Hose adapter GL 14 compl. Olive GL 14 compl. Screw cap GL 14. Ecrou chapeau GL 14. Oring GL 14. Joint torique GL 14. Hose stem GL 14, bent. Olive GL 14, coudee. Aufbau AAndere Schliffe siehe Matrix auf Seite 34. Other Joints see matrix at page 34. Autre rodages voir matrix page 34. Aufbau RE B. Assembly RE B. Rotavapor RE111,121,140. Assemblage RE BAssemblage B Glass assembly B compl. for RE. Assemblage B compl. pour REGasket KD22. Joint KD22PTFE tube, 210 mm. Tuyau PTFE, 210 mmDistribution piece glass. Tete de distribution verreCondenser. RefrigerantVacuum connection. Raccord de videScrew cap with insert spring. Couplage avec ressortIntroduction stopcock compl. Robinet d'introduction compl.Uberwurfmutter. Distribution piece with gasketTete de distribution avec jointKSClip. KSPinceVapour duct. Conduit de vapeurScaffolding for Assembly BSupport pour assemblage BRod, 300 x 12. Tige, 300 x 12Condenser clamp with rod. Bride pour refrigerant et tigeCross piece. Piece en croixSaveclip 29. Agrafe de securite 29Hose adapter GL 14 compl. Olive GL 14 compl.Screw cap GL 14.



<http://www.drupalitalia.org/node/72135>

Ecrou chapeau GL 14Oring GL 14. Joint torique GL 14Hose stem GL 14, bent. Aufbau B. Autre rodages voir matrix page 34Assemblage RE CPiege a froid 2pieceGlass assembly C compl. for RE. Assemblage C compl. pour REGasket KD22. Joint KD22Oring. Joint torique, 88,3 x 5,3Cold finger. Partie interieurCold Trap mantle. Manteau pour piege a froidScrew cap with insert spring. Couplage avec ressortKSClip. Conduit de vapeurOberwurfmutter kompl. Cold Trap with Gasket andPiege a froid avec joint etScaffolding for Cold TrapSupport pour assemblage piegeRod, 300 x 12. Tige, 300 x 12Clamp for Cold Trap with rod. Bride pour piege avec tigeSaveclip 29. Kihlfalle 2teilig. Andere Schliffe siehe Matrix auf Seite 34. Autre rodages voir matrix page 34AufbauELS. Assembly EL S. Assemblage EL S. Rota vapor EL131,141Matrix Seite 34. Other STJ see. Matrix page 34. Autres CN voir. Matrix page 34Glasaufbau S kompl. zu EL. Assembly S Standard. Assemblage S. Glass assembly S compl. for EL. Assemblage S compl. pour EL. Einlagefeder. Insert spring. Ressort. Auflagering zu Kuhlerflansch. Flat seal for condenser flange. Joint plat pour refrigerant. Kuhler. Condenser. Refrigerant. Vakuumbstutzen. Vacuum connection. Raccord de vide. Oberwurfmutter mit Einlagefeder. Oberwurfmutter, di 50,5 mm. Screw cap, di 50.5 mm. Ecrou chapeau, di 50,5 mm. PTFESchlauch, 300 mm. PTFE tube, 300 mm. Tuyau PTFE, 300 mm. PTFERing zu 00934. Ablaufventil kompl.,PTFE washer for 00934. Drain valve compl.,Soupape decoulement compl.,Drehknopf. Knob. Bouton. Deckel. Cover. Couvercle. Oberwurfmutter. Screw cap. Ecrou

chapeau. Ventilspindel. Valve spindel. Pivot de robinet. Gewindestück PVC. Thread piece PVC. Piece filetee PVC. Dichtung. Gasket. Joint. Vakuumszwischenstück Vacuum adapter Piece intermediaire de vide Einleithahn kompl. KSKlammer. RJClip. Pince RS. Klammer NS 19. STJ 19 clip. Pince CN 19. Stab, 3 0 0 x 1 2. Rod, 300 x 12. Tige, 3 0 0 x 1 2. Verteilstück nur Glas. Distribution head glass only.

<https://www.dulamari.com/images/bosch-wfk2801-repair-manual.pdf>



Piece de distribution verre seulement. Verteilstück kompl. Distribution head compl. Piece de distribution compl. Stativ kompl. Scaffolding compl. Support compl. Schutzring PTFE. Protecting ring PTFE. Anneau de protection PTFE. Ausziehwerkzeug KD 26. Seal extractor KD 26. Outil d'extraction KD 26. Oberwurfmutter, di 51,5 mm. Screw cap, di 51.5 mm. Ecrou chapeau, di 51,5 mm. Sicherheitsklammer 29. Übergangsstück Flansch. Transition pipe, flange. Raccord de reduction, joint a bride. Vakuumdichtungssystem. Vacuum Sealing System. Systeme du joint pour le vide. KD26 Vakuumdichtung. KD26 Vacuum seal. KD26 Joint pour le vide. Stützring, rostfrei, Stahl. Supporting ring, stainless steel. Anneau de support, inox. Viton O Ring. Viton O ring. Anneau 0 viton. PTFE Schutzring. Schutzring mit 2 O Ringen. Protecting ring with 2 Orings. Anneau de protection avec Scillaucholive GL 14 kompl. Oberwurfmutter GL 14. O Ring GL 14. Olive GL 14, gebogen. Rondelle PTFE pour 00934 Aufbau EL E. Assemblage EL E. Rotavapor EL131,141 Assembly E. Assemblage E Glasaufbau E kompl. zu EL. Glass assembly E compl. for EL. Assemblage E compl. pour EL. Ecrou chapeau avec ressort. Schraubkappe SVL 15. Screw cap SVL 15. Screw cap, di 50.5mm. Couvercle SVL 15. Einleithahn Glas. Introduction stopcock glass. Robinet d'introduction verre. Expansionsgefäß. Expansion vessel. Vase d'expansion. Bogenrohr. U-tube. Tube en U. Vakuumszwischenstück. Vacuum intermediate piece. Piece intermediaire d'aspiration. Einleithahn kompl. Introduction stopcock compl. Robinet d'introduction compl. KSKlammer. Vacuum gasket KD26. Joint pour le vide KD26. Verteilstück. Distribution head. Piece de distribution. Rod, 300 x 12. Tige, 300 x 12. Condenser scaffolding compl. Support pour refrigerant compl. Cross piece. Piece en croix. Condenser clamp with rod. Bride pour refrigerant avec tige.

<https://duluthtaxiservice.com/images/bosch-wfk2801-washing-machine-manual.pdf>



<http://pulsrmedia.com/wp-content/plugins/formcraft/file-upload/server/content/files/1626c3a1a83556---98-4runner-service-manual.pdf>

<http://www.AUTODESGUACECOIN.COM/ckfinder/userfiles/files/canon-imageprograf-w6400-user-manual.pdf>

<http://www.drupalitalia.org/node/72136>